



KOBELL MUSIC-01

## KOBELL MUSIC-01

Timbre electrónico de CC

KOBAN

## Instalación del timbre de puerta

No instale el timbre en ambientes con temperaturas y humedad altas. El timbre funciona correctamente en ambientes ventilados y secos.

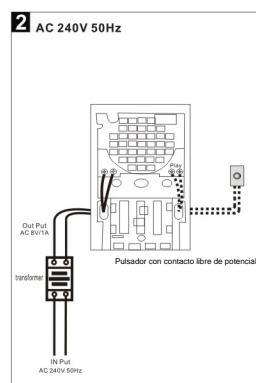
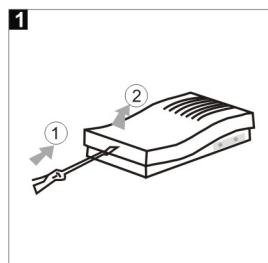
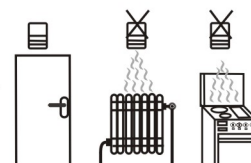

Este timbre tiene 12 melodías que se seleccionan por rotación. Se puede alimentar con 4 pilas AA o mediante una conexión al transformador externo de 8V, 1A. No se pueden utilizar pulsadores iluminados. No monte el timbre sobre la puerta.

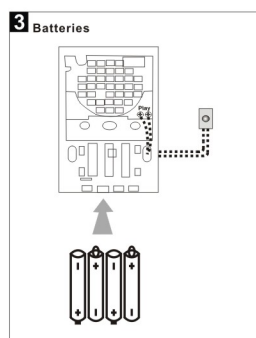

Manual de instrucciones | 2



www.grupotemper.com

## KOBELL MUSIC-01

KOBAN

Campainha electrónica de potência DC

Instalação da Campainha  
Não instale a campainha próximo a ambientes que apresentem alta temperatura ou humidade. A campainha funciona optimamente em ambientes secos e bem ventilados.

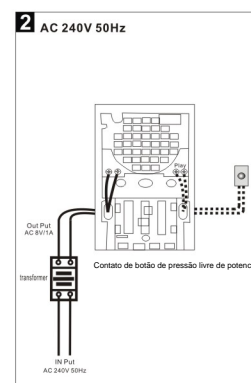
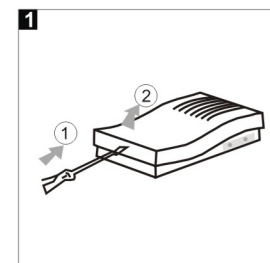
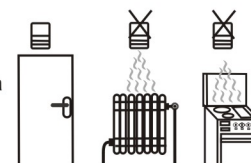

Esta campainha possui 12 melodias e uma selecção de melodia da rotação. A unidade pode ser alimentada por 4 baterias 'AA', ou conectada à um transformador externo de 8V, 1A. A iluminação de botões não pode ser usada. Não instale a campainha na porta.

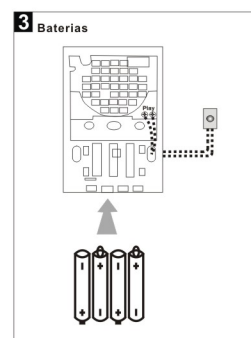

Manual de instrucciones | 3



www.grupotemper.com

## KOBELL MUSIC-01

Sonnette électronique CC

KOBAN

## Installation de la sonnette de porte

N'installez pas la sonnette à proximité de températures élevées ou de l'humidité. La sonnette fonctionne bien dans les environnement secs et ventilés.

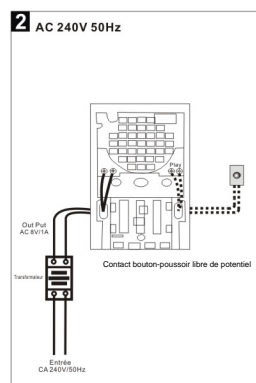
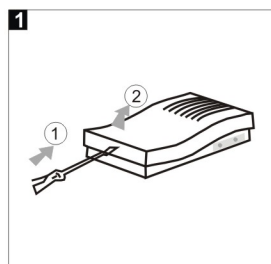
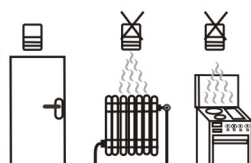

Ce carillon a 12 tonalités et choisit une tonalité tour à tour. Il peut être alimenté avec 4 piles « AA », ou connecté sur un transformateur externe 8V, 1A. Les touches illuminées ne peuvent pas être utilisées. Ne montez pas le carillon sur une porte.

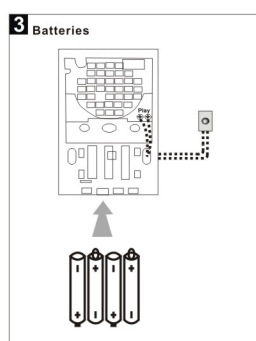

Manual de instrucciones | 4



www.grupotemper.com

## KOBELL MUSIC-01

DC Electronic door bell

KOBAN

## Door Bell Installation

Do not install the bell near high temperature and humidity. The bell works well in ventilated and dry environment.

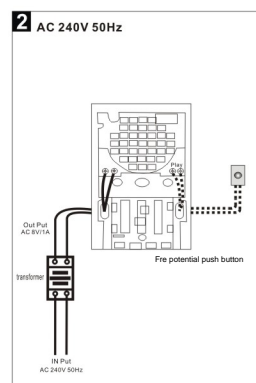
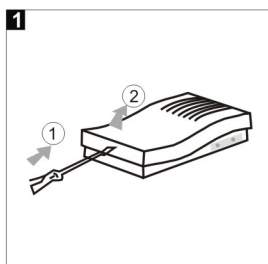
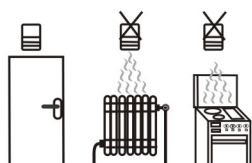

This chime have 12 tunes and selects a tune in rotation. It can be powered by 4 "AA" batteries, or connected with a 8V, 1A external transformer. Lighted pushes cannot be used. Do not mount chime on door.

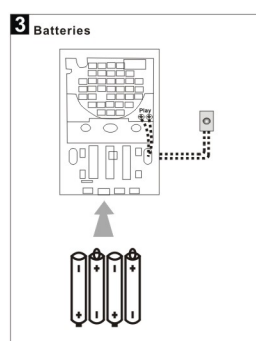

Manual de instrucciones | 5



www.grupotemper.com



TEMPER ENERGY INTERNATIONAL S.L.  
Polígono industrial de Granda, nave 18  
33199 • Granda - Siero • Asturias

Teléfono: (+34) 902 201 292  
Fax: (+34) 902 201 303  
Email: info@grupotemper.com

Una empresa  
del grupo

