

www.grupotemper.com



KDP5
Mando a distancia

Mando a distancia
Remote control

KOBAN 

Índice

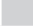
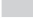
| | | |
|---------------------------|---|---|
| Especificaciones técnicas | 3 |  |
| Contenido del embalaje | 3 |  |
| Características | 3 |  |
| Consideraciones previas | 3 |  |
| Instalación | 4 |  |
| Función de los botones | 6 |  |
| Resolución de problemas | 9 |  |

Especificaciones técnicas

| | |
|-------------------------------|---------------------------|
| Alimentación | 3V DC (pila CR2032) |
| Alcance de transmisión | 10 metros aproximadamente |
| Ángulo de transmisión | 35° |
| Temperatura de funcionamiento | 0°C a +45°C |
| Temperatura de almacenaje | -25°C a +70°C |

Contenido del embalaje

| Icono |  |  |  |  |  |
|----------|---|---|---|---|--|
| Artículo | Mando a distancia | Soporte | Tornillos $\Phi 4 \times 25 \text{mm}$ | Adhesivo doble faz | Manual |
| Cantidad | 1 | 1 | 2 | 1 | 1 |

Características

Con el mando a distancia KDP5 ya no necesitará de escaleras para programar los detectores de presencia instalados en techos o lugares de difícil acceso. Presionando el botón  podrá establecer el umbral de luz para el cual la iluminación debe activarse.

Consideraciones previas

El mando a distancia incluye pila. Retire la tira aislante de la misma antes de empezar a utilizar el mando. (Ver FIG. 1).

Para más información acerca de la programación consulte las instrucciones del detector que esté configurando.



Instalación

Colocación y cambio de pila

Mantenga el mecanismo de bloqueo presionado, retire el soporte de la batería y coloque la nueva pila (tipo CR2032 3V DC). Asegúrese que la polaridad es correcta y vuelva a colocar el soporte de la pila en su posición. (Ver FIG. 2).

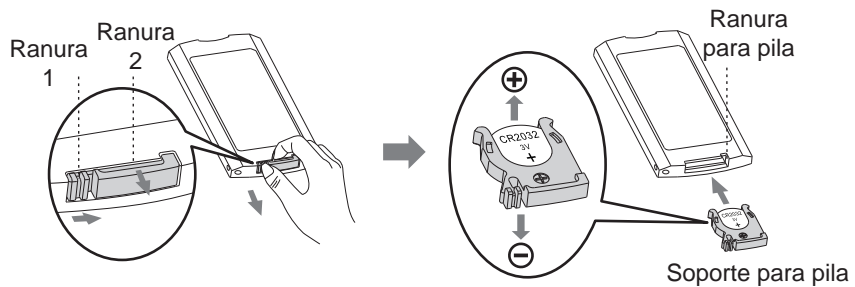

FIG.2

Colocación del soporte de pared

Fije el soporte a la pared con los tornillos suministrados (Ver FIG. 3-A) y deslice el mando a distancia en el mismo (Ver FIG. 3-B).

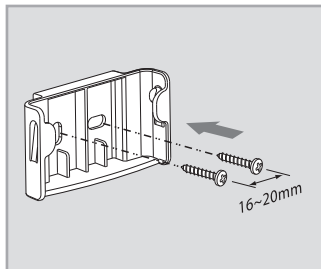

FIG.3-A

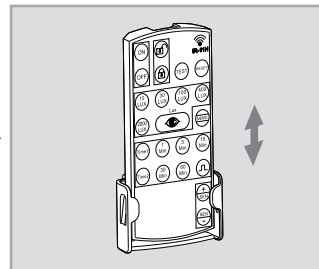

FIG.3-B

También puede fijar el soporte a la pared mediante el adhesivo de doble faz suministrado (Ver FIG. 4-A), luego deslice el mando en el soporte (Ver FIG. 4-B).

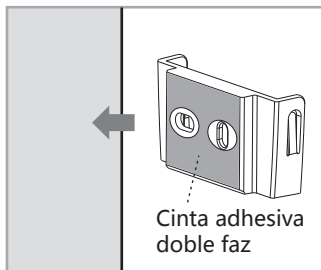

FIG.4-A

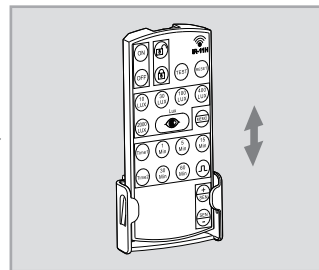









FIG.4-B

Función de los botones

Nota

- Presione el botón para comenzar a utilizar el mando.
- Mediante el botón podrá copiar los ajustes de luminosidad y tiempo a otros detectores.
- Cada pulsación de cualquier botón transmitirá una señal durante 1 segundo como máximo. Si se presionan dos o más botones simultáneamente no se transmitirá ninguna señal.
- El detector de presencia confirmará la recepción de la señal mediante el parpadeo de su LED durante 2 segundos.
- Todos los ajustes realizados para la carga II (CH2) no serán válidos si el detector tan sólo tiene una carga conectada.













| Botón | Función |
|-------|---|
| | <p>Encendido de la carga I (CH1) durante 4 u 8 horas</p> <ul style="list-style-type: none"> • Presionando el botón la carga del detector se conectará durante 4 u 8 horas dependiendo del modelo de detector. • La carga se desconectará tras un periodo de 4 u 8 horas y volverá al modo automático. Presione el botón de nuevo para salir de este “modo de 4 u 8 horas” y volver al modo automático. También puede cortar la alimentación del detector de presencia durante 5 segundos para que este vuelva al modo automático. • Si estamos en el modo ON puede apagar la carga I (CH1) presionando el botón . |
| | <p>Apagado de la carga I (CH1) durante 4 u 8 horas</p> <ul style="list-style-type: none"> • Presionando el botón la carga del detector se desconectará durante 8 u horas. • El detector volverá al modo automático tras 4 u 8 horas, o presionando de nuevo este botón si aún no han transcurrido las 4 u 8 horas. También puede cortar la alimentación del detector de presencia durante 5 segundos para que este vuelva al modo automático. • Si estamos en el modo OFF puede pasar al modo ON presionando el botón . |





| Botón | Función |
|---|--|
|  | <p>Bloqueo de funciones del mando Presionando este botón se bloquearán el resto de botones excepto los botones  y .</p> |
|  | <p>Desbloqueo de funciones del mando</p> <ul style="list-style-type: none"> • Presionando este botón se desbloquearán el resto de botones del mando y podrá comenzar a usarlo para configurar el detector de presencia. • Tras el desbloqueo el canal por defecto del mando será el CH1 (Carga I). • El detector se bloqueará automáticamente 5 minutos después de la última operación si no se presiona el botón . |
|  | <p>Modo Test</p> <ul style="list-style-type: none"> • Presionando este botón se entrará en el modo Test. Camine a través del área de detección, la carga I (CH1) y su luz LED se encenderán durante dos segundos una vez el detector se haya activado (la reacción dependerá del nivel de luminosidad configurado). La carga II (CH2) no realizará ninguna operación durante este modo. |
|  | <p>Memorización de ajustes y duplicación a otros detectores</p> <ol style="list-style-type: none"> 1. Configure los valores deseados de luminosidad y tiempo mediante el mando a distancia. 2. Presione el botón MEMO durante 3 segundos apuntando al detector, los valores de Lux y tiempo se guardarán mediante el parpadeo del LED del detector. 3. Apunte hacia otro detector y pulse el botón MEMO durante 1 segundo, los valores guardados serán transferidos al nuevo detector. 4. Repita estos pasos con cuantos detectores sea necesarios. Si no hay datos guardados en el mando a distancia el detector no mostrará ninguna indicación al presionar el botón MEMO. 5. Para borrar los datos guardados retire la pila durante 5 segundos o presione el botón RESET. |
|  | <p>Restablecer ajustes del detector Presiones este botón apuntando hacia el detector para borrar los datos guardados en el mando y restablecer los ajustes del detector.</p> |

KDP5 mando a distancia

Mando a distancia

KOBAN®

| Botón | Función |
|--|--|
|  10 Lux ↓  2000 Lux | Ajuste de la luminosidad (LUX) Presionane el botón correspondiente para configurar el nivel de luminosidad para la cual el sistema debe conectarse. La Carga II (CH2) es independiente de este valor. |
|  | Lectura de la luz ambiente Si los valores de luminosidad establecidos no son los deseados puede medirse el nivel de luminosidad actual. Siga los siguientes pasos: Presione el botón hasta que el LED del detector parpadee para entrar en el modo de aprendizaje durante 10 segundos. Una vez se haya memorizado el valor de luminosidad la carga y su LED se encenderán durante 5 segundos para, posteriormente, volver al modo automático. Nota: si la luz ambiente está fuera del rango 10-2000Lux, tras los 10 segundos de aprendizaje, el LED del detector parpadeará rápidamente durante 5 segundos para indicar que ha fallado y el nivel de luminosidad del sistema se establecerá en 10 ó 2000Lux dependiendo si la luminosidad actual se encuentra por encima o por debajo del rango. |
|  Time1  Time2 | Selección de la carga para ajustar el temporizador Presione el botón  para seleccionar la carga I (CH1), y el botón  para seleccionar la carga II (CH2). El botón  no tendrá función si únicamente hay conectada una carga. |
|  1 Min. ↓  60 Min. | Ajuste del retardo de las cargas Seleccione la carga a ajustar mediante los botones   , la luz LED parpadeará durante dos segundos, después presione el botón de tiempo correspondiente para ajustar el tiempo de retardo, la luz LED parpadeará durante dos segundos cuando esté confirmado. |
|  1 Sec. | Modo de impulso corto para la carga I (CH1) En este modo la carga I (CH1) se encenderá durante 1 segundo y se apagará durante 9 segundos cuando se detecte movimiento. El detector actuará de acuerdo al movimiento y el ajuste de luminosidad establecido. |

| Botón | Función |
|--|---|
|   | <p>Ajuste de la sensibilidad del detector</p> <p>Presione los botones   para ajustar la sensibilidad. Con cada pulsación la sensibilidad aumentará o se reducirá un 10% y la luz LED parpadeará. Cuando la sensibilidad esté a su valor máximo o mínimo la luz LED permanecerá encendida durante 2 segundos.</p> |

Resolución de problemas

| Problema | Posible causa | Solución sugerida |
|----------------------------------|--|---|
| El detector no recibe la señal | <ol style="list-style-type: none"> 1. Se ha excedido la distancia máxima de transmisión. 2. La pila está agotada. 3. El detector está estropeado. | <ol style="list-style-type: none"> 1. Sitúese dentro del rango de transmisión y apunte directamente al detector. 2. Cambie la pila. 3. Compruebe el funcionamiento del detector. |
| No hay señal | <ol style="list-style-type: none"> 1. La pila está agotada. 2. Se han presionado dos o más botones simultáneamente. | <ol style="list-style-type: none"> 1. Cambie la pila. 2. Presione sólo un botón. |
| Fallo en la transmisión de señal | El mando está en modo bloqueo. | Desbloquee el mando. |





Contents

| | | |
|--------------------------|----|---|
| Technical specifications | 11 | ■ |
| Package contents | 11 | ■ |
| Features | 11 | ■ |
| Initiation of operation | 11 | ■ |
| Installation | 12 | ■ |
| Push button function | 14 | ■ |
| Troubleshooting | 17 | ■ |

Technical specifications

| | |
|-----------------------|------------------------|
| Rated Voltage | 3V DC (CR2032 battery) |
| Transmission Range | Approx. 10m |
| Transmission Angle | 35° |
| Operating Temperature | 0°C to +45°C |
| Storage Temperature | -25°C to +70°C |

Package contents

| | | | | | |
|----------|---|---|---|---|--|
| Pattern |  |  |  |  |  |
| Item | Remote controller | Bracket | Wood screw Φ4 x 25mm | Double-sided adhesive tape | Manual |
| Quantity | 1 | 1 | 2 | 1 | 1 |

Features

No need of climbing ladders, the ceiling mounted presence detector can be programmed easily and safely with KDP5 RC remote control.

By pressing  button the ambient light level can be read-in as the threshold of switching on / off for detector's load.

Initiation of operation

A battery for the IR remote controller is included. Please remove the insulation sheet before initial use (See FIG.1).

For further information on programming, please refer to the operating instructions for the device you are setting up.

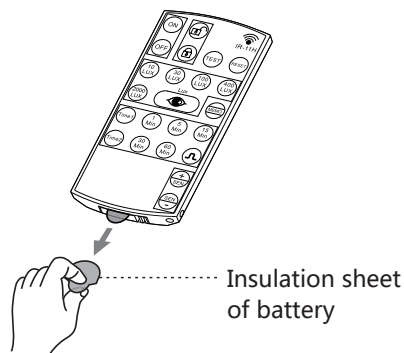

Installation

Battery installation and replacement

Keep the locking mechanism pressed down and pull out the battery holder, then put in a new battery (type CR2032 3V DC). And please make sure that the polarity is correct, then insert the battery holder into the housing (See FIG.2).

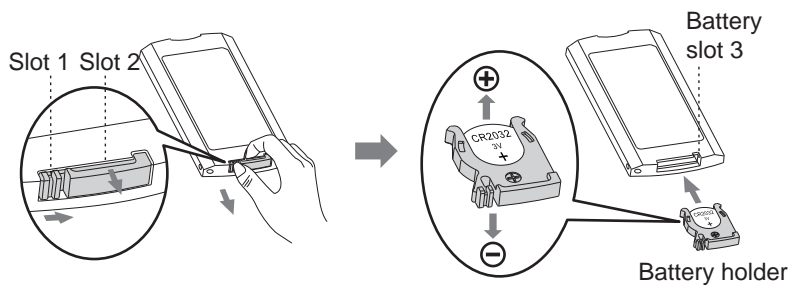

FIG.2

Wall bracket installation

Fix the wall bracket on the wall by attached wood screw (See FIG.3-A), then slide the controller into it (See FIG.3-B).

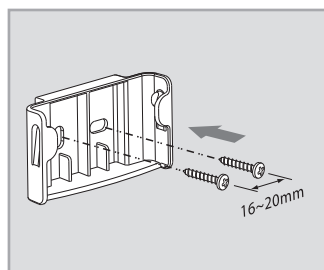

FIG.3-A

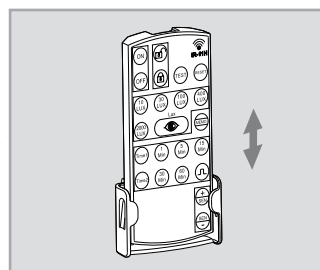

FIG.3-B

Stick the wall bracket on the wall by attached double-sided adhesive tape (See FIG.4-A), then slide the controller into it (See FIG.4-B).

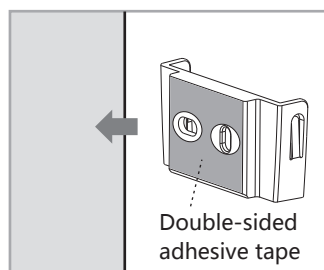

FIG.4-A

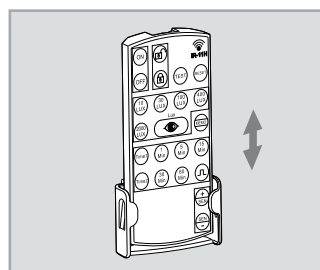







FIG.4-B

Push button function

Note

- Press button to start setting operation.
- By using button, the settings of light level and time can be duplicated to other detectors.
- Each operation on button can transmit signal for maximum 1sec. No signal will be transmitted if two or more buttons are pressed simultaneously.
- Presence detector confirms the signal reception by LED flashing for 2sec.
- All the settings for load II (CH2) are invalid while detector has only one load (channel).

















| Button | Function |
|--------|--|
| | <p>To set load I (CH1) on for 4hrs or 8hrs</p> <ul style="list-style-type: none"> • By pressing ON button, the load of detector will be turned on for 4hrs or 8hrs depending on the incorporated product. • Load will be turned off after 4hrs or 8hrs and return to auto mode. Or press ON button again to exit this "4hrs or 8hrs on mode" during this period, detector will return to auto mode. Or switching off power supply of presence detector for 5sec and re-supply it again to lead detector to auto mode. • Load I (CH1) can be lead to off mode by pressing OFF button under on mode. |
| | <p>To set load I (CH1) off for 4hrs or 8hrs</p> <ul style="list-style-type: none"> • By pressing OFF button, the load connected to detector will be turned off for 4hrs or 8hrs depending on the incorporated product. • Detector will return to auto mode after 4hrs or 8hrs. Or press OFF button again to exit this "4hrs or 8hrs off mode" during this period, detector will return to auto mode. Or switching off power supply of presence detector for 5sec and re-supply it again to lead detector to auto mode. • Load I (CH1) can be lead to on mode by pressing ON button under off mode. |
| | <p>To lock KDP5 RC buttons</p> <p>By pressing this button, KDP5 RC buttons will be locked and no key function is workable (Except & buttons).</p> |







| Button | Function |
|---|---|
|  | <p>Unlock KDP5 RC buttons</p> <ul style="list-style-type: none"> • By pressing this button, KDP5 RC buttons will be unlocked. Thereafter, the remote controller can be used to set presence detector. • The default channel is CH1 (Load I) after unlocking KDP5 RC. • When operating KDP5 RC to detector under unlock mode, detector will lock automatically 5min after the last operating if  button is not pressed. |
|  | <p>Test mode</p> <p>By pressing  button to enter into Test mode, it is confirmed by flashing of detector' s LED for 2sec.</p> <p>Walking through the detection coverage, both load I (CH1) and detector' s LED turn on 2sec once detector is triggered (Reaction is regardless of Lux value).</p> <p>LoadII(CH2) has no reaction in test mode.</p> |
|  | <p>The previous setting values can be stored and duplicated to other detector</p> <ol style="list-style-type: none"> 1. Set the desired Lux and time values on one detector by using the remote controller. 2. Then by pressing MEMO button for approx. 3sec aiming to above detector, the Lux and time settings of this detector will be saved into this remote controller by detector's LED flashing. 3. By pressing MEMO button again for approx. 1sec aiming to a new detector, the saved settings can be duplicated to the one. 4. Transfer the settings to detectors desired by repeating above last step. If no data is saved in the remote controller, detector has no reaction after press MEMO button. 5. Battery removed for more than 5sec or MEMO button is pressed, all the data in IR remote controller will be deleted. |
|  | <p>To reset settings on presence detector</p> <p>By pressing RESET button aiming to the detector, all settings on presence detector will go back to potentiometers' settings, and all MEMO data will be deleted.</p> |

KDP5 remote control

Remote control

KOBAN 

| Button | Function |
|--|---|
|   | <p>To adjust Lux value By pressing corresponding button, the selected light level threshold is set to presence detector for switching on the connected load. Load II (CH2) is independent of Lux value.</p> |
|  | <p>To read-in the actual ambient light level Actual ambient light level can be read-in as threshold for switching the connected load, if the provided Lux values do not match user's requirement. The steps are as below: Press  button till detector's red LED flashing to enter into learning mode, learning time is 10sec. Then the actual ambient light level is read-in confirmed by both load and LED turn on for 5sec to indicate KDP5 RC learning successfully and then turn off. Afterwards, it returns to Auto mode. Note: If the ambient light level is out of the range of 10 - 2000Lux, detector will learn for 10sec, then LED flashes quickly for 5sec to indicate KDP5 RC learning is failed, and the alternative of 10Lux or 2000Lux value will be stored depending on under 10Lux or above 2000Lux value.</p> |
|   | <p>Select load for time setting By pressing  to set the delay off time value of load I (CH1), and  to set the delay off time value of load II (CH2).  is invalid if the detector has only one load.</p> |
|   | <p>Time setting for Time / Time1 or Time2 By pressing   to select the load desired to set the delay off time value. Either  or  is pressed, LED flashes 2sec, and then press the corresponding time value button to set it, which is confirmed by detector's LED flashing for 2sec.</p> |
|  | <p>Short impulse mode for load I (CH1) By pressing  button to enter into short impulse mode, it is confirmed by flashing of detector's LED for 2sec. Load I (CH1) will be on 1sec and off 9sec when detector detects movement. Detector acts depending on movement and the pre-set Lux value under short impulse mode.</p> |

| Button | Function |
|--|--|
|   | <p>Adjustment on sensitivity of detector</p> <p>By pressing   buttons to set the sensitivity of sensor. Each time the user presses the button, the sensitivity of sensor would increase or decrease 10% with indication of red LED flashing.</p> <p>By pressing  button to increase the sensitivity of sensor.</p> <p>By pressing  button to decrease the sensitivity of sensor.</p> <p>When the sensitivity of sensor is at its highest or lowest level which is confirmed by red LED keeping on for approx. 2sec.</p> |

Troubleshooting

| Problem | Possible cause | Suggested solution |
|----------------------------------|---|---|
| Detector fails to receive signal | <ol style="list-style-type: none"> 1. Exceed the transmission range. 2. Low battery power. 3. Detector works abnormally. | <ol style="list-style-type: none"> 1. Operate within transmission range, and ensure KDP5 RC aims directly to the detector. 2. Replace a new battery. 3. Check the trouble of detector, then refer the TROUBLE SHOOTING of detector manual for repairing. |
| No signal | <ol style="list-style-type: none"> 1. Low battery power. 2. Press two or more buttons once. | <ol style="list-style-type: none"> 1. Replace battery. 2. Press one button once. |
| Fail to transmit signal | In locked mode. | Unlock the controller. |

KDP5 remote control

Remote control

KOBAN 

GARANTÍA • WARRANTY GARANTIE • GARANTIA

2 años
years
années
anos

TEMPER ENERGY INTERNATIONAL S.L. garantiza este aparato por 2 años ante todo defecto de fabricación. Para hacer válida esta garantía, es imprescindible presentar con este resguardo el ticket o factura de compra.

TEMPER ENERGY INTERNATIONAL S.L. garantit cet appareil pour le durée de 2 années contre tout défaut de fabrication. Pour le service de garantie, vous devez présenter ce reçu avec du ticket de caisse ou la facture.

TEMPER ENERGY INTERNATIONAL S.L. guarantees this device during 2 years against any manufacturing defect. For warranty service, you must present this receipt with the purchase receipt or invoice.

TEMPER ENERGY INTERNATIONAL S.L. garantia este aparelho contra defeitos de fábrica ate 2 anos. Para o serviço de garantia, você deve apresentar este recibo com o recibo de compra ou fatura.

Ref. Art.

Nº serie / Serial number

Nombre / Name / Nom / Nombre

Fecha de venta / Date of purchase
Date de vente / Data de venda

Sello establecimiento vendedor / Dealer stamp
Cachet du commerçant / Cambo da firma

KOBAN 

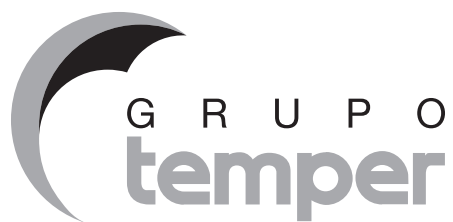

TEMPER ENERGY INTERNATIONAL S.L.
Polígono industrial de Granda, nave 18
33199 • Granda - Siero • Asturias

Teléfono: +34 902 201 292

Fax: +34 902 201 303

Email: info@grupotemper.com

Una empresa
del grupo

